

MULTI WEIR STRUCTURE

- Designed to suit large scale cotton farmers.
- Successful in reactive soils.
- In-built base with no need for a concrete base to be poured on site
- Can be customized as per clients request, with additional centre modules available to achieve the volume required.
- Available with walkway for easy access to open individual weir modules.
- Ideal for isolated farmers without access to onsite pouring.
- These units are available with steel boards or winch control tarp systems with the NEW solar powered 'wireless automated control system' that can monitor and control the stop straight from your smart phone.

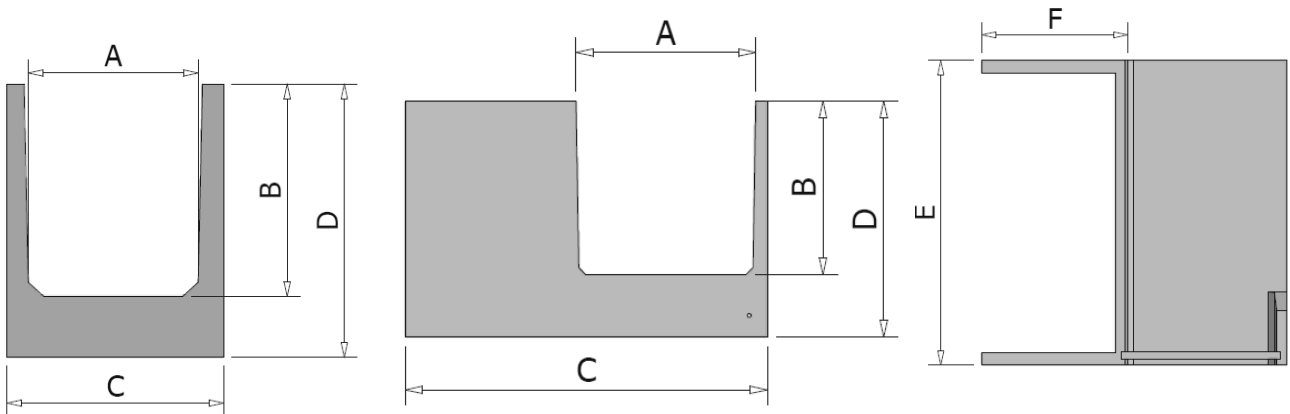
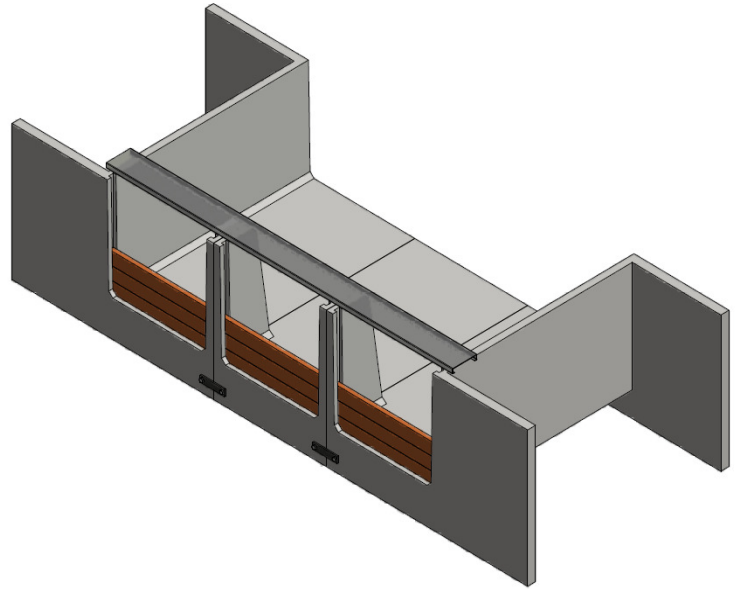

CODE	PRODUCT	A	B	C	D	E	F	APPROX. WEIGHT
		MM	MM	MM	MM	MM	MM	
6600C	1200 x 900 Centre Module	1200	900	1400	1330	2200	-	1840kg
6600L	1200 x 900 Left Wing	1200	900	2500	1330	2200	1300	2740kg
6600R	1200 x 900 Right Wing	1200	900	2500	1330	2200	1300	2740kg
6610C	1200 x 1200 Centre Module	1200	1200	1400	1630	2200	-	1940kg
6610L	1200 x 1200 Left Wing	1200	1200	2500	1630	2200	1300	3090kg
6610R	1200 x 1200 Right Wing	1200	1200	2500	1630	2200	1300	3090kg
6620C	1200 x 1500 Centre Module	1200	1500	1400	1930	2200	-	2030kg
6620L	1200 x 1500 Left Wing	1200	1500	2500	1930	2200	1300	3420kg
6620R	1200 x 1500 Right Wing	1200	1500	2500	1930	2200	1300	3420kg